

# CERTIFICATE OF LOCATION OF GOVERNMENT CORNER

NORTH QUARTER Corner of Section 16, Township 108, Range 42, 5TH P.M.

STATE OF MINNESOTA, County of MURRAY

At the corner location shown on the sketch:

On 10/9/15 found a railroad spike  
DATE

left monument as found,  lowered monument,  removed monument (explain)

On \_\_\_\_\_ placed a \_\_\_\_\_  
DATE

### SKETCH OF REFERENCE TIES

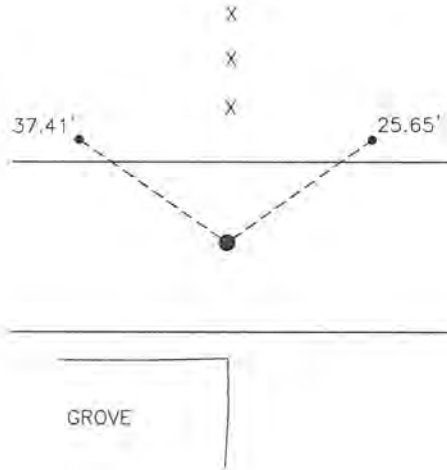

Minnesota State Plane Coordinate  
System Murray County Datum  
NAD83 (1996)

N: 216457.485  
E: 466696.782

1/2" iron in slope NE 25.65'  
1/2" iron in slope NW 37.41'

Statement of evidence relative to this corner location is on back of page.

I hereby certify that this document and the data contained herein was prepared by me or under my direct supervision.

  
SIGNATURE 3-21-16  
DATE

Registration No. 50343

Land Surveyor,  Professional Engineer  
 County Surveyor,  County Engineer

OFFICE OF THE COUNTY RECORDER

County of MURRAY

I hereby certify that this document was filed in the Co. Recorders office at 11:00 A.M on the 18<sup>TH</sup> day of OCTOBER A.D. 20 16

County Recorder Evelyn C. Larson

By \_\_\_\_\_, Deputy

DOCUMENT NO. \_\_\_\_\_

## Statement of Evidence

In, 1861, L.G.W. Fletcher did the original subdivision of the township.

On September 30, 1974, Murray County Highway Department found a field stone at the corner. Set an 18 inch steel pin over the field stone.

In 1983, Murray County Highway Department set a railroad spike at the road surface.

On October 9, 2015, Bueltel-Moseng Land Surveying found a railroad spike in the centerline of road and in line with fence to the north. It fit county ties from 1974 survey.